

TOMIM HOSSAIN

60, B.B. GHOSH ROAD, BURDWAN

Email: - hossaintamim@gmail.com

GST: - 19ABVPH3636D2ZF

MOBILE: - 9732284811 / 9434029811

Ref. :-

Date :- 20/03/2026

DECLARATION FOR PROJECT LOCATION

CO-ORDINATE -

Latitude - 23.14403(N) & Longitude - 87.52234(E)

SITE PLAN FOR PROPOSED G+IV STD. RESIDENTIAL FLAT TYPE CUM COMMERCIAL (RETAIL USE) BLDG. OF RAMJABIBI KAJI @ RAMIJA KHATUN, W/O-LATE MAHAMMAD KAJI (DEVELOPED BY TOMIM HOSSAIN S/O MOAKHER HOSSAIN) ON R.S. PLOT NO. - 838/929, L.R. PLOT NO. - 1605, RS KH NO - 1343, L.R KH. NO. - 4362, IN MOUZA- RADIHANAGAR, J.L. NO. - 39, AT WARD NO.-31, MAHALLA - MD YASIN ROAD, HOLDING NO - 19, UNDER BURDWAN MUNICIPALITY, P.S.-BURDWAN, DIST.- PURBA BARDHAMAN.

- a) AREA OF LAND - 689.145 SQMT. (AS PER DEED)
- b) AREA OF LAND - 437.361 SQ.MT. (AS PER RECORD)
- c) AREA OF LAND - 355.86 SQMT. (AS PER SITE)

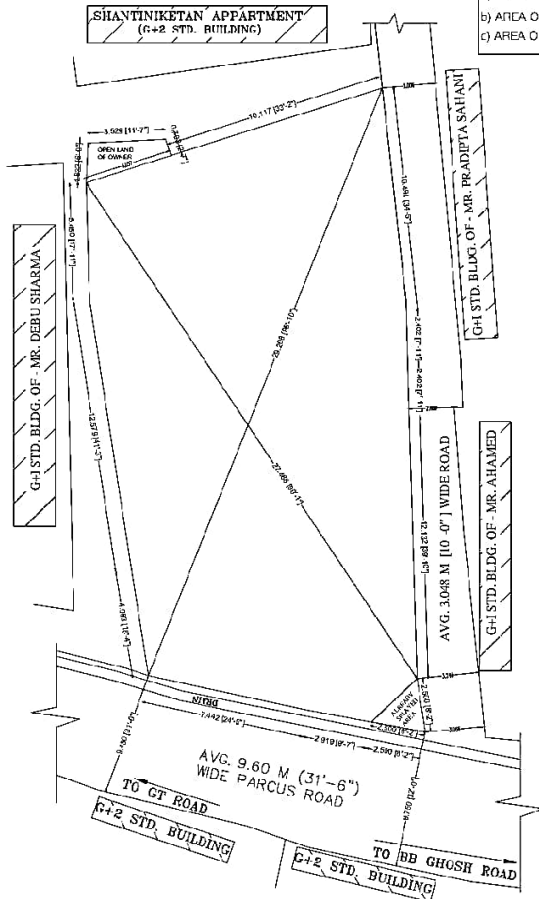

N
SCALE - (1:175)



N 23°14'40.34850" (LAT)
E 87°52'2.34430" (LON)
Altitude: 37 m a.s.l.
20/03/26, 11:10 AM
Location provider: Fused
Parkas Road
Burdwan 713101
West Bengal
India

FOR, TAMIM HOSEN (DEVELOPER)

TOMIM HOSSAIN

Tamim Hossain
Proprietor